

CONTRACTORS SHALL VERIFY AND DIMENSIONS BEFORE ANY JOB COMMENCES. ALL SHOP DRAWINGS SHALL BE SUBMITTED TO THE SUPERINTENDENT AND MANUFACTURE. SHALL NOT COMMENCE PRIOR TO THE RETURN OF UNMARKED SHOP DRAWINGS ISSUED BY THE CONSULTANT. FIGURED DIMENSIONS SHALL TAKE PRECEDENCE OVER SCALED THIS DRAWING SHOULD BE READ IN CONJUNCTION WITH ALL RELEVANT CONTRACT SPECIFICATIONS AND DRAWINGS COPYRIGHT OF THIS DRAWING IS VESTED IN WARDLE

General Notes

- PERFORATIONS OCCUR IN FOUR SIZES:
 ○ = DIAMETER OF 10mm
 ○ = DIAMETER OF 15mm
 ○ = DIAMETER OF 20mm
 ○ = DIAMETER OF 25mm
- ALL DIGITAL ARTWORK FILES WILL BE PROVIDED BY ARCHITECT.
- CONTRACTORS TO REFER TO RELATED ARCHITECTURAL SPECIFICATION SECTIONS FOR 3D MODEL INTEGRATION REQUIREMENTS.
- NO VENEER AT EDGE UNLESS OTHERWISE NOTED

SOUTH FACE: S-L4-01 THROUGH S-L4-05

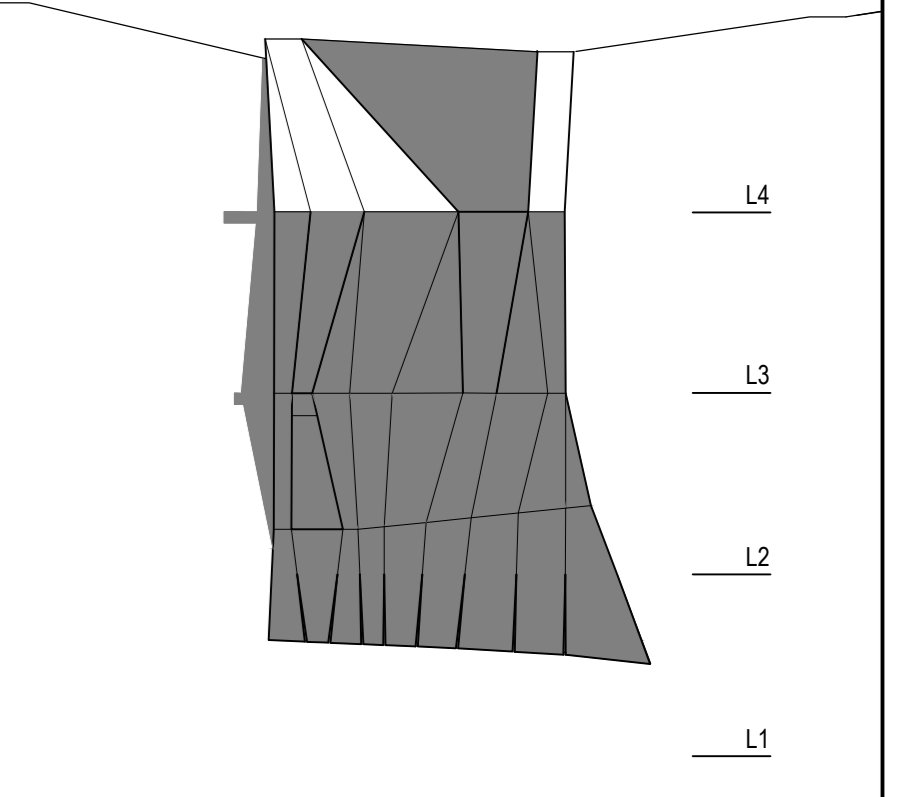

06	SC	CONSTRUCTION ISSUE	-	06.01.14
05	SC	TENDER ISSUE	-	21.08.13
04	JC	100% CD - TENDER ISSUE	-	07.08.12
03	JC	90% CD ISSUE	-	10.06.12
02	JC	75% CD ISSUE	-	13.07.12
01	JC	50% CD ISSUE	-	01.06.12

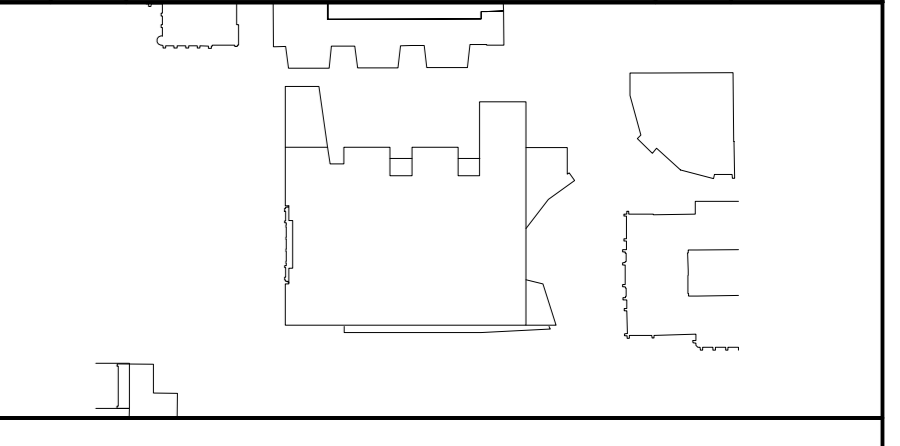

NADAAA
 NADAAA
 1302 Washington Street No. 2 Boston Massachusetts 02118 USA
 Telephone: +1 617 442 8332
 Facsimile: +1 688 442 1417
 Email: nadaa@nadaaa.com

John Wardle Architects
 © 2011 John Wardle Architects
 Level 10, 180 Russell Street, Melbourne Victoria 3000 Australia
 Tel: +613 9654 8700 www.johnwardlearchitects.com

Client: **University of Melbourne Parkville Campus**

Project: **Faculty of Architecture Building and Planning**

Title: **HANGING STUDIO UNFOLDED PANELS**

Project No.	0913	Scale	1:10 @ A0 1:20 @ A2
Drawing No.	AR5133	Revision	A
Date	JAN 2014	Dwn	
		Co-Ord	
		Chk	

FILENAME: ###

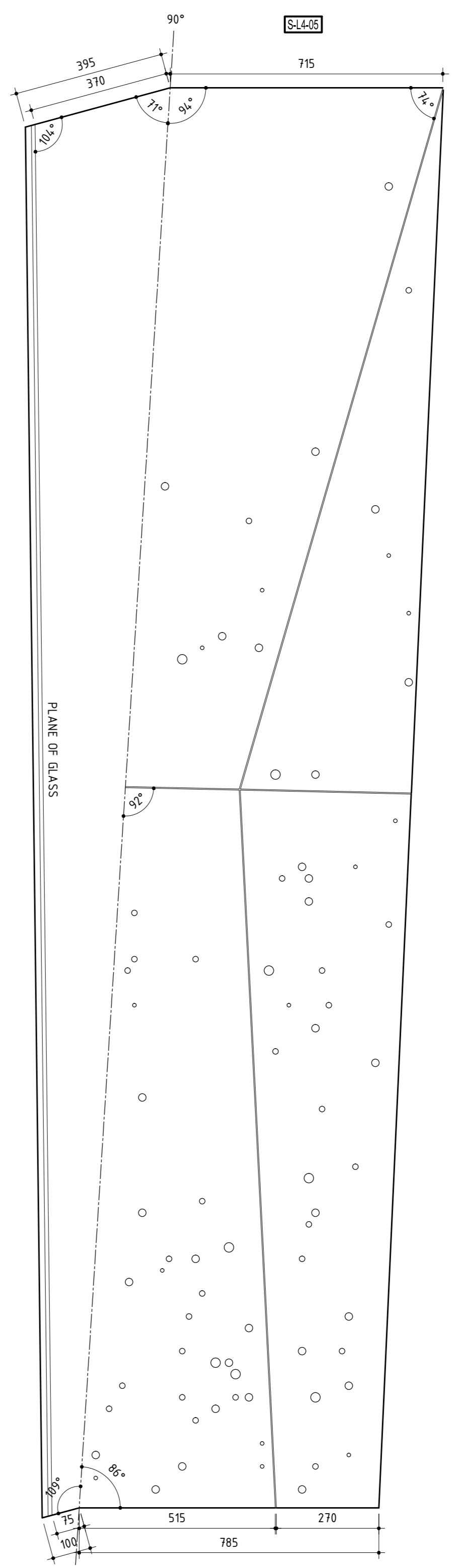
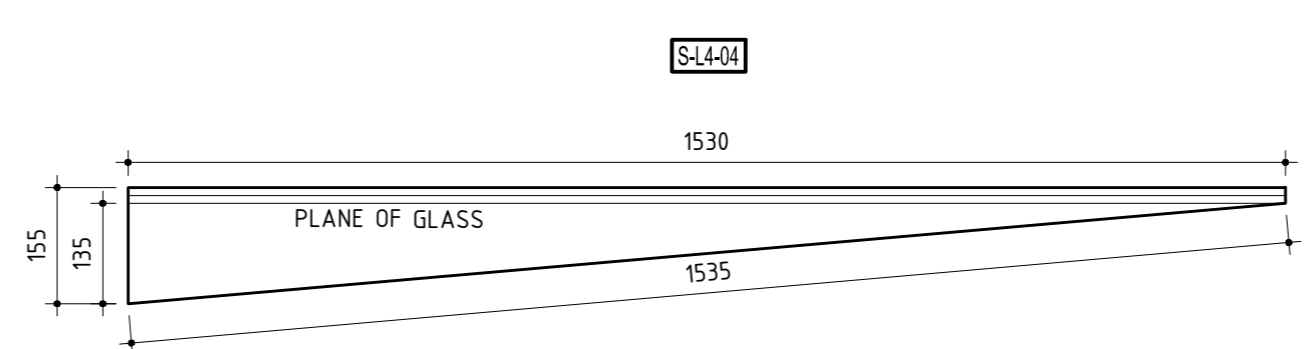
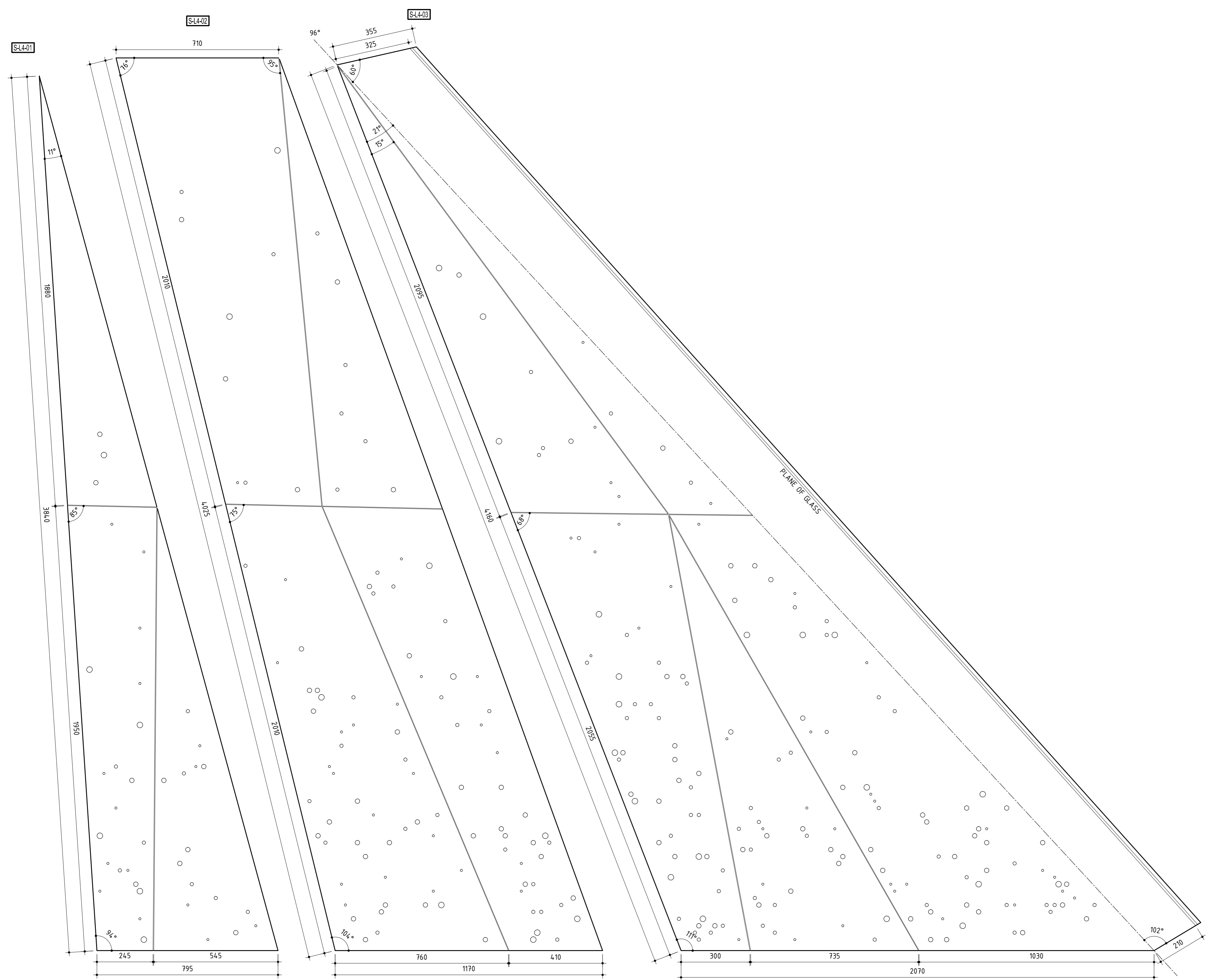

01 UNFOLDED PANELS: S-L4-01 THROUGH S-L4-05
SCALE 1:10

FOR CONSTRUCTION